

MAJESTIC

TT64

Instruction manual



New MAJESTIC S.p.A.
Via Rossi Martini, 41
26013 Crema (CR) – Italia
www.newmajestic.com
info@newmajestic.com
MADE IN CHINA



Per scaricare il manuale d'istruzioni inquadra il QR code:

To download the instruction manual frame QR code:

Um die Bedienungsanleitung herunterzuladen, scannen Sie den QR-Code:

Pour télécharger le manuel d'instructions, scannez le code QR:

Para descargar el manual de instrucciones, escanee el código QR:

For safe use and maximum performance, please read this manual carefully before use.

SAFETY WARNINGS

CAUTION: TO REDUCE THE RISK OF ELECTRIC SHOCK, DO NOT DISASSEMBLE THE APPLIANCE. THERE ARE NO USER SERVICEABLE PARTS. FOR REPAIRS, CONTACT QUALIFIED TECHNICAL PERSONNEL.

To prevent electric shock or fire hazard, do not expose to rain or moisture.



This symbol warns that before using the unit it is necessary to read the instruction manual carefully.

IMPORTANT NOTES

- Use must be permitted only to adults and responsible persons, adequately trained on damages deriving from incorrect use.
- Keep the appliance and its cord out of the reach of children.
- The appliances can be used by people with reduced physical, sensory or mental capabilities or with lack of experience and knowledge if they are supervised or if they have received instructions regarding the safe use of the appliance and understand the dangers involved.
- Children must not use the appliance as a toy.
- Do not allow the appliance to be used by children or disabled people without supervision.
- Keep away from pets.
- Never use the appliance in places where the cable, plug and the product itself can come into contact with water or wet surfaces. Do not use the appliance outdoors, as rain could create short circuits. Do not touch the appliance with wet hands.
- Avoid installing the unit in the locations listed below:
 - Locations exposed to direct sunlight or near heat-generating equipment, such as radiators;
 - On top of other appliances that may radiate excessive heat;
 - Places that block ventilation or are humid or dusty;
 - Environments subject to constant vibration.
- Do not place accessories with naked flames, such as lighted candles, on the appliance.
- Do not try to repair or intervene on the appliance yourself. Incorrect interventions or tampering can invalidate the guarantee. In case of damaged parts or suspected malfunction, stop using immediately and consult qualified personnel. Never immerse the appliance in water or other liquids. Do not place vessels filled with liquids (e.g. vases) on top of the apparatus.
- Do not touch the appliance with wet hands and do not place it near sinks, tubs or containers of liquids. Only use the product if it is in perfect condition. If the appliance has been immersed in water or is damaged, contact qualified personnel.
- The product should not be used if it has been dropped or if there are visible signs of damage.
- Exposure to high volume levels can cause hearing problems, including permanent damage. Susceptibility to hearing loss varies from person to person, however constant exposure to high volume levels is harmful to everyone. Moderate the volume level.
- Refer only to qualified service personnel to avoid voiding the warranty. For information and questions, contact the New Majestic S.p.A. technical assistance service.

BOX CONTENT

1 TT64	1 piece
2 Power adapter	1 piece
3 45 RPM vinyl disc adapter	1 piece
4 Speakers	2 pieces
5 Instruction manual	1 piece
6 Warranty card	1 piece

DESCRIPTION

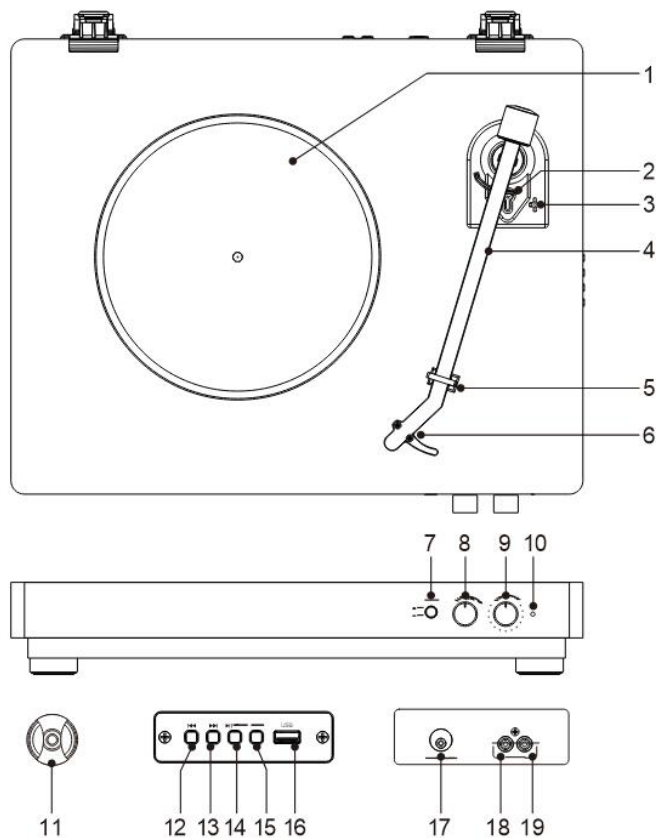

1. Platter
2. Lifting Bracket
3. Lift lever
4. Tonearm
5. Tonearm lock
6. Cartridge with stylus
7. Speed selector (33 – 45 RPM)
8. Mode button: PHONO / BT IN / USB / BT OUT
9. Volume control knob/Power knob
10. Indicator LED light
11. 45 RPM adaptor
12. Previous track
13. Next track
14. Play/Pause/Delete
15. Mode / REC key
16. USB port
17. DC 12V (2A) power jack
18. Speaker out jack-Right channel
19. Speaker out jack-Left channel

DUST COVER ASSEMBLE

Install the hinge clamp in the position of the dust cover slot in the correct direction (Hinges are in the attachment).

Then install the dust cover on the turntable, note the hinge clamp should be aligned with the hinge base on the turntable.

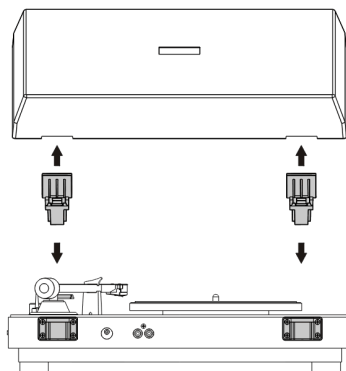

MAINS CONNECTION

EXTERNAL SPEAKER CONNECTION

Plug the speaker cable into the SPK OUT audio output on the back of the turntable.

NETWORK CONNECTION

Insert the supplied power adapter into the socket and into the product then press the POWER knob.

Adjust the desired volume by turning the appropriate knob.

Select the desired source between PH (Turntable), BT IN and BT OUT (Wireless Audio) and USB using the appropriate knob.

To activate Standby mode, long press the POWER knob. To reactivate the device, press the POWER knob again. If the device is not used for a long period, disconnect the power supply from the mains.

PLAYING RECORDS

- Place the record on the turntable. If you use a 45-rpm record, use the appropriate adapter.
- Select the Turntable (PH) source with the appropriate knob.
- Using the platter rotation speed selection button, choose between 33 or 45 rpm, depending on the type of vinyl you want to play.
- Remove the head protectors being careful to avoid damage to the stylus (any breakages are not covered by the warranty):

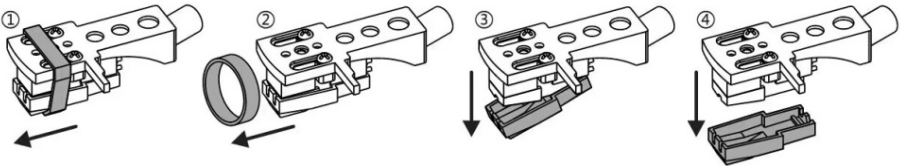

- Turn on the product and adjust the volume to an appropriate level.
- Open the hook that blocks the tone arm, lift it using the dedicated lever and position it over the record. The platter will begin to rotate automatically.
- Lower the arm with the appropriate lever to make the needle adhere to the surface of the record and start playing.
- To manually stop or resume playback, raise or lower the arm using the appropriate lever.
- At the end of use, return the arm to the initial position, lower it using the dedicated lever and lock it with the hook.
- The product is equipped with the Autostop function which automatically stops the rotation of the platter when the record is finished.

NOTE:

In Turntable mode, if no audio input for 15mins, it will enter standby automatically. In standby, the Pink light flashes slowly and then turn off, press the Power knob to wake up the machine.

- Autostop function may not be compatible with some discs. If the disc does not have a standard format or if it has an area that does not match the default settings of this product, the Autostop function may stop playback of the disc prematurely.

WIRELESS AUDIO FUNCTION

- Make sure the turntable arm is on the stand.
- Select the Wireless Audio (BT IN) source with the appropriate knob and turn on the product, a sound will be emitted to confirm the activation of the Wireless Audio function.
- Start the relevant function on the external device and search for the name "TT 64" (enter 0000 if required).
- After pairing, start playback from the external device.
- Press the NEXT TRACK / PREVIOUS TRACK buttons to go to the next song / return to the previous song
- During music playback you can briefly press the Play/Pause button to pause playback. To resume playback, press the Play/Pause button again.

NOTE: In wireless audio mode, if there is no audio signal for 15 minutes, the product will automatically enter standby. Press the power knob to wake up the machine.

Audio playback on external devices via Wireless Audio

- Make sure the turntable arm is in the rest position.
- Rotate the knob to BT OUT to activate the search for external devices, the status LED will start flashing.
- Turn on a compatible external device (e.g. speakers, headphones, etc.), activate the Wireless Audio function and make sure it is in search mode.
- The turntable will automatically connect to the external device if compatible and the status LED will turn solid pink.
- Start playback on the turntable.
- When the BT OUT transmission function is turned on, the TT 64 will randomly pair with nearby wireless devices. It is recommended to only turn on the nearby wireless device that needs to be paired.

NOTE: In wireless audio mode, if there is no audio signal for 15 minutes, the product will automatically enter standby. Press the power knob to wake up the machine.

USB PLAYBACK FUNCTION

- Make sure the turntable arm is on the stand.
- Select the USB source with the appropriate knob and turn on the product.
- Insert a USB stick (containing songs in MP3 format) into the appropriate input, playback will start automatically.
- Press the PLAY / PAUSE button to pause / resume playback.
- Press the NEXT TRACK / PREVIOUS TRACK buttons to go to the next song / return to the previous song or hold them down for a long time to fast forward / fast rewind through the song being played.

ATTENTION:

- Compatibility with all commercially available USB storage devices cannot be guaranteed.
- External devices that require a rated voltage greater than 5V and a rated current greater than 200mA are not supported.
- If you use a USB extension cable, the connected storage device may not be recognized or work properly.
- Only use USB storage devices formatted with the FAT16/FAT32 file system.

NOTE: In wireless audio mode, if there is no audio signal for 15 minutes, the product will automatically enter standby. Press the power knob to wake up the machine.

RECORDING VINYL/WIRELESS AUDIO ON USB

- Insert a USB stick into the appropriate slot and start playback from the source you want to record (Turntable / Wireless Audio).
- Long press the REC button to start recording, a sound will confirm the start of recording.
- To stop recording, long press the REC button again, a double sound will confirm the end of recording.
- The recordings are saved in the "RECORD" folder of the inserted USB stick.
- To play saved recordings, select the USB source and long press the MODE button.
- Click the previous and next track keys to select the audio files in the USB.

Deleting recordings from USB

Long press the MODE button to enter the recording folder and start playing the recordings. Press the previous/next track buttons to select the recording file you want to delete, and then long press the "Del" button.

REPLACING THE STYLUS

Take off the stylus

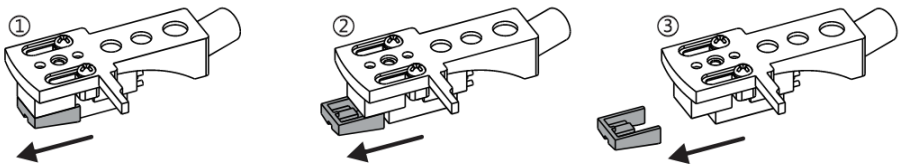

To remove the stylus, grasp the tone arm and the plastic stylus holder and gently pull the white stylus holder towards you, away from the cartridge. Repeat the procedure in reverse to insert the pin.

TROUBLESHOOTING

Problem	Solution
Unit will not power on	Make sure that the unit's power cord is connected to an appropriate electrical outlet and the wall socket is switched on.
There is no sound	Rotate the volume knob clockwise to increase the volume.
The vinyl record will not play	Make sure the phono function is selected.
	Make sure you have selected the right speed (33, 45RPM).
Nothing will play via USB device	Make sure the memory device is properly inserted in the USB port and the correct function is selected.

NOTE: If normal operation cannot be obtained, unplug the power cord from the power outlet and plug it in again.

TECHNICAL SPECIFICATIONS

Supports 33 and 45 rpm vinyl (45 rpm adapter included)

Integrated vinyl autostop

Wireless Audio Input and Output Playback

USB port for playing MP3 files

Audio recording from Vinyl/Wireless Audio on USB stick

External STEREO speakers 15W x 2

RMS power 20W

Maximum power 200W (P.M.P.O)

AC power supply 100/240V (50/60Hz) – DC 12V (2A)

Main unit dimensions 42.2 (L) x 33.6 (D) x 12.5 (H) cm

Speaker dimensions 13.8 (L) x 13.8 (D) x 24 (H) cm

Main unit weight 4.22 Kg

Total weight 7.02 KgColor BK

Pack of 1 pcs.

EAN 8002829817632



WEEE Logo (Waste electrical and electronic equipment)



Class II, double insulation



Six levels of energy efficiency



Indoor use

INFORMATION TO USERS OF DOMESTIC APPLIANCES



Pursuant to art. 25 Paragraph 1 of Legislative Decree 14 March 2014, n. 49 "Implementation of Directives 2011/65/EU and 2012/19/EU relating to the reduction of the use of hazardous substances in electrical and electronic equipment, as well as waste disposal".

The crossed-out bin symbol shown on the appliance or on its packaging indicates that the product at the end of its useful life must be collected separately from other waste. The user must therefore deliver the equipment that has reached the end of its life to the appropriate separate collection centers for electronic and electrotechnical waste, or return it to the retailer when purchasing a new equipment of an equivalent type, on a one to one basis.

Adequate differentiated collection for the subsequent sending of the decommissioned equipment to environmentally compatible recycling, treatment and disposal helps to avoid possible negative effects on the environment and health and promotes the reuse and/or recycling of the materials of which the equipment is made.

Illegal disposal of the product by the user involves the application of the sanctions set out in the current legislation.

Any batteries or rechargeable batteries contained in the device must be disposed of separately in the appropriate containers for the collection of used batteries.



Disposal of used batteries must take place at the appropriate separate collection centers or according to local regulations. Batteries compliant with directive 2013/56/EC.

WEEE eco-fee paid where due - EEE Register No.: IT08020000001647

BATTERY eco-contribution paid where due – BATTERY Register No.: IT19070P00005533

GENERAL WARRANTY CONDITIONS FOR PRODUCTS OF New MAJESTIC S.p.A.

Dear Customer, thank you for your purchase and we remind you that the product complies with current construction and safety regulations.

- Should anomalies or defects in the product be found, New Majestic S.p.A. offers a conventional Guarantee subject to the conditions set out here (specifying that the conventional Guarantee does not affect the consumer's rights pursuant to Legislative Decree no. 206 of 06/09/2005). The Warranty exclusively refers to the free repair or replacement of the individual components or of the entire good recognized as defective in manufacturing.
- The Warranty period will not be renewed or extended following subsequent resale, repair or replacement of the product itself.
- The parts repaired, replaced or the total exchange of the product will be guaranteed for a period of 60 days starting from the date of the repair or replacement and naturally for the remaining duration of the Guarantee itself.
- The Guarantee is valid from the date proven by a valid fiscal document (receipt or purchase invoice) for a period of 24 months in case of purchase with fiscal receipt and 12 months in case of purchase with fiscal invoice (VAT number).
- There are some goods which, due to their normal characteristics, are perishable over time or subject to wear and tear deriving from use, therefore, for the accessories included in the sales package, the Warranty is valid for 12 months.
- A rechargeable accumulator is considered defective and can be replaced under the 12-month warranty only when it is interrupted, i.e. it no longer supplies energy and the voltage at its ends is Zero Volt. In the event that the ability to deliver energy is reduced compared to the new product (consumption/wear) the Warranty period will be 6 months.

Not covered by Warranty:

- Deterioration due to wear of the aesthetic parts and of all the components that may be defective due to negligence or negligence in use, incorrect maintenance or circumstances that cannot be traced back to manufacturing defects of the appliance.
- User manuals, third party software, configurations, applications or data downloaded by the customer.
- Defects caused by improper use of the product (drops, pressure, deformation or use of sharp objects).
- Opening, modification or repair of the product by persons other than the Authorized Assistance Centre.
- Serial numbers, date of manufacture, barcode or IMEI * that appear to be erased, altered or illegible.

For interventions under Warranty, please contact one of the Authorized Service Centres of New Majestic S.p.A., the complete list of which can be consulted on the website www.newmajestic.com, or at the point of sale where the product was purchased, by delivering the duly completed Warranty coupon and attaching the receipt relating to the purchase.

WARNING:

It is advisable to keep both the packaging, and all the accessories contained therein intact, since in case of sending to the technical laboratory it is better to use the original packaging with all its accessories.

New Majestic S.p.A.